

CODE//ALARM®

Technology that talks to cars and trucks.™

Remote Vehicle Control System

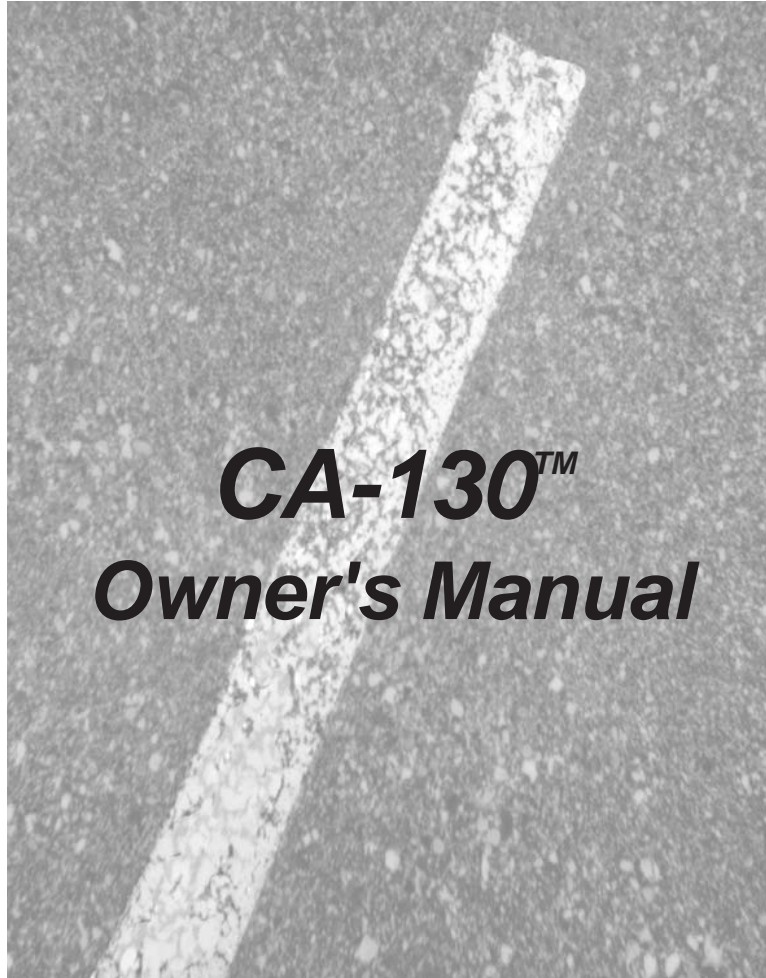

CA-130™

Owner's Manual

***Security and Convenience
System***

IMPORTANT NOTE: The operation of the Security and Convenience System as described in this manual is applicable to most vehicles. However, due to the configuration of some vehicles, some functions AND/OR SAFETY PRECAUTIONS may not apply. Please see your installing dealer for more information.

2 **Table of Contents**

Features and Benefits of the Code Alarm CA-130™	3
Using Your Remote Transmitter	4
Arming the Security System	
<i>Pre-arm Mode</i>	
Disarming the Security System	
<i>Attempted Intrusion Identification</i>	
Disabling the IT-s™ Interior Theft Sensor	5
Two-Stage Door Unlock	
Activating the Trunk Release Feature	
Aux 1	
Turning on the Vehicle Headlights/Aux 2	
AUX 3	
AUX 4	
Using the Car Finder Feature	
Personal Protection Alarm (Panic)	
Using Valet Mode	6
Automatic Convenience Options	6
When Your Security System is Triggered	7
The Interior Status Indicator	7
System Maintenance	7
Changing the Remote Control Battery	
System Maintenance	8
Adding Remote Controls to Your System	
Deleting Lost or Stolen Remote Controls from Your System	
Emergency Disarm Procedure	9
E-code Coded Override procedure	
Emergency Disarm Button Location	9
Basic Troubleshooting	10
Installer Programmed Options	10
Personalized Transmitters Option	11
Your Code-Systems, Inc. Limited Lifetime Warranty	12
Code Systems Theft Protection Plan	13

Features and Benefits of the Code Alarm CA-130™ 3

- **Two Easy-to-Use Weather-Resistant Remote Controls**
The remote controls included with the Code Alarm CA-130™ utilize durable, moisture resistant cases and sealed rubber buttons for reliability and long life. Rolling code technology prevents the transmitter signals from being duplicated. The button functions are clearly labeled to make the Code Alarm CA-130™ simple to operate.
- **All Entrances Protected**
Opening any door or entrance protected by the security system triggers the alarm's 125db siren (or vehicle horn) and flashes the vehicle parking lights.
- **Starter Disable**
The Code Alarm CA-130™ protects your vehicle from theft by disabling the starter when the system is armed.
- **IT-s™ Interior Theft Sensor**
This patented sensor uses infra-red technology to reliably detect vehicle impact associated with attempted intrusion. The IT-s sensor guards against vehicle body damage, and theft of the vehicle's equipment (such as airbags) and personal belongings.
- **Remote Keyless Entry**
The Code Alarm CA-130™ conveniently locks and unlocks the vehicle's doors and opens the trunk or hatch (if equipped and connected) by remote control.*
- **Personal Protection Features**
Remote Panic Alarm, Headlight Control, Illuminated Entry, and Car Finder are among an array of features that enhance personal safety. **May require additional components and/or labor
- **Interior Status Indicator**
The bright-blue warning light is an effective visual deterrent to a would-be thief.
- **PowerRange™ Antenna**
This long-range antenna allows you to operate the Code Alarm CA-130™ from distances of up to 1/8 mile.
- **E-Code Coded Override System**
If this feature is enabled, it will allow you to enter a personal 4-digit code that only you will know. This will be used for overriding the system in the case of an emergency or a lost transmitter.

*If vehicle is equipped with power door locks and they are connected to the alarm system by your installer.

4 Using Your Remote Transmitter

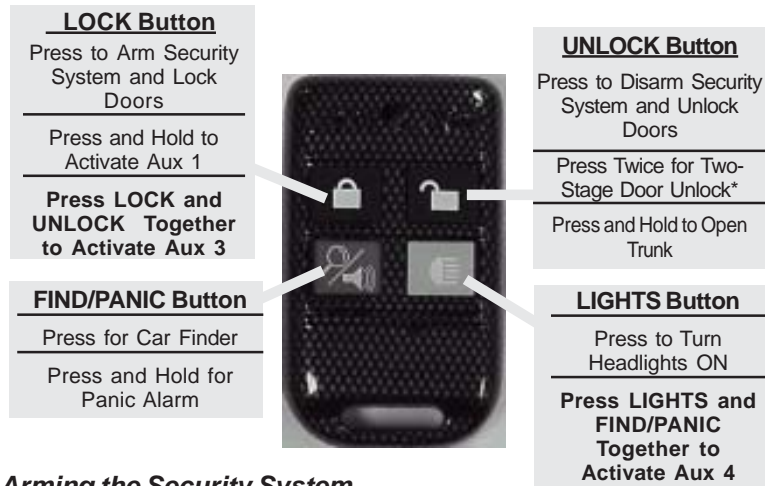

Arming the Security System

To arm the system, exit the vehicle, close all doors, then press* the LOCK button. The siren** will “chirp” twice† and the parking lights will flash twice, indicating the system is armed. The doors will also lock at this time (if equipped and connected). The status indicator (blue warning light on the dash) will blink steadily, once per second.

Pre-arm Mode

If the siren chirps and the parking lights flash only once, this indicates that the vehicle courtesy light is on, or that an entrance is not closed securely. Check to see that doors, hood, and trunk are properly closed. Once all entrances are secured (and the courtesy light is off), the system will chirp / flash again. The system is now fully armed. (If the entrance is not secured within 4 minutes, the system will arm and ignore the unsecured entrance until it is closed.)

Disarming the Security System

To disarm the system, press the UNLOCK button. The siren will chirp and the parking lights will flash once, and the doors will unlock. The courtesy light will turn on for 1 minute, or until the vehicle is started.

Attempted Intrusion Identification

If the siren chirps four times when disarming, this indicates that the system was triggered in your absence. The status indicator will also flash rapidly. Perform the following operation to determine the protected zone that triggered the system:

After disarming, press the emergency override button. The siren will chirp to indicate the cause of the alarm trigger:

1 chirp	IT-s Interior Theft Sensor
2 chirps	Door
3 chirps	Hood
4 chirps	Trunk/Optional Sensors
5 chirps	Ignition was turned on

* Throughout this manual, ‘press’ refers to pressing for less than 1 second; ‘press and hold’ refers to pressing for more than 1 second.

** ‘Siren’ also refers to the vehicle horn if it is used as the alarm sounding device.*

† If you have chosen the Silent Arming Option, the siren will not sound when arming or disarming until the appropriate button is pressed a second time.

Disabling the IT-s Interior Theft Sensor

It may be necessary at times to disable the IT-s Interior Theft Sensor, especially when parking in areas (like parking garages) where extreme vibration may cause false alarms. Press the **LOCK** button and then press the **FIND/PANIC** button within two seconds of pressing **LOCK** to disable the interior theft sensor. The siren will chirp two times to indicate that the sensor is disabled. The sensor will become enabled again the next time the system is armed normally.

Two-Stage Door Unlock

If this feature is enabled on your system, pressing **UNLOCK** one time will unlock only the driver's door. Press **UNLOCK** again within 1 minute to unlock all doors.

Activating the Trunk Release Feature

Press and hold **UNLOCK** to open the vehicle trunk or hatch (if equipped and connected). If this button is used to operate another accessory, the accessory will stay active for as long as the button is held.

Using AUX 1

If this feature is enabled on your system, press and hold **LOCK** to activate Aux 1.

Turning on the Vehicle Headlights (Aux 2)

Press the **LIGHTS** button to turn on the vehicle headlights. The lights will stay on for 20 seconds, or until **LIGHTS** is pressed again.

Using AUX 3

If this feature is enabled on your system, pressing **LOCK** and **UNLOCK** simultaneously will activate Auxilliary 3.

Using AUX 4

If this feature is enabled on your system, pressing **FIND/PANIC** and **OPTION** simultaneously will activate auxillary 4.

Using the Progressive Car Finder Feature

Press **FIND/PANIC** on the remote control to locate your vehicle. The vehicle horn will emit five short chirps at low volume, increasing in volume each of three times the button is pressed.

Personal Protection Alarm (Panic)

Press and hold the **FIND/PANIC** button to activate the vehicle siren and parking lights for 30 seconds. (If the vehicle horn is connected, the horn will "pulse" for 30 seconds.) Press any remote control button to turn off the Panic alarm.

6 Using Your Remote Transmitter (cont.)

Using Valet Mode

If the Passive Arming feature is enabled on your system, Valet mode temporarily prevents the alarm system from arming automatically. This is useful when fueling or servicing your vehicle.

To enter Valet Mode:

With the vehicle ignition key in the ON position, press the LOCK and UNLOCK buttons simultaneously. The blue dashboard warning light (status indicator) will turn on for one second, then turn off. This indicates that the system is in Valet mode. Once the ignition is turned off, the status indicator will emit a quick double-flash pattern.

Note: In Valet mode, all keyless entry, convenience features operate normally.

To exit Valet Mode:

With the vehicle ignition key in the ON position, press the LOCK and UNLOCK buttons simultaneously. The blue dashboard warning light (status indicator) will turn on for one second, then turn off. This indicates that the system has exited Valet mode.

Automatic Convenience Options

The Code Alarm CA-130™ performs a variety of automatic functions to enhance security and comfort. Some of these features are programmable at the time of installation. Please see your installer for further details.

Illuminated Entry

When the alarm system is disarmed, the vehicle courtesy lights will turn on for 1 minute, or until the vehicle is started or the system is re-armed.

Illuminated Exit

When removing the key from the ignition, the vehicle courtesy lights will turn on for 1 minute, or until the system is armed.

Automatic Arming

The Code Alarm CA-130™ will arm automatically 1 minute after the key is removed from the ignition. This feature can be temporarily disabled by placing the system into Valet mode.

Ignition Lock

If all doors are closed and the vehicle is started with the key, the doors will automatically lock.

Ignition Unlock

When turning the ignition key off, the doors will automatically unlock. When

When your Security System Is Triggered

7

The Code Alarm CA-130™ will trigger if one of the following events occurs while the system is armed:

- Any protected entrance is opened
- The vehicle ignition is turned on
- The vehicle is jolted hard enough to signal the impact sensor

Once the alarm is triggered, the siren (or horn) sounds and the vehicle parking lights flash for 30 seconds. The system will then re-arm, awaiting the next intrusion attempt. To stop the siren while keeping the system armed and doors locked, press the LOCK button while the system is triggered.

The Status Indicator is a high-intensity red light mounted in a visible location on the vehicle dashboard. This red light gives a visual indication of the alarm system's state of operation. Note the chart below:

If the Status Indicator is...then the Security System
Off	is disarmed
Flashing Slowly	is armed
Flashing Very Quickly	was triggered in your absence (see Attempted Intrusion ID - page 4)
Flashing Intermittently (2 flashes, off, 2 flashes)	is in Valet mode
On (not flashing)	is in Pre-arm mode

System Maintenance

Changing the Remote Control Battery

The 12-volt alkaline battery (GP-23A) supplied in your remote control should last approximately one year, depending on usage. When the battery begins to weaken, you will notice a decrease in range, or the distance from your vehicle that your remote transmitter will operate. Follow the instructions below to change the remote transmitter battery.

1. Insert the edge of a coin into the slot at the side of the remote control. Twist the coin to pry the remote control halves apart.
2. Remove the old batteries and replace with new ones.
Be sure to observe the (+) and (-) signs in the battery compartment.
3. Carefully snap the case halves back together, then test the remote control.

8 **System Maintenance (cont.)**

Adding Remote Controls to Your System

The Code Alarm CA-130™ has the ability to operate from up to eight (8) remote controls. Follow these instructions to add a remote control to your system.

1. Make sure the security system is disarmed and the ignition is off.
2. Open the driver's door.
3. Turn vehicle ignition on.
4. Press and hold the emergency override button.
After 10 seconds, the siren or horn will sound three (3) times. This indicates that the unit has entered the remote control programming mode.
5. Release the emergency override button.
6. Press the LOCK button (button 1) on the remote control to be programmed.
The siren or horn will sound once, indicating that the system has "learned" that remote control.
7. Repeat step 6 for any additional remote controls.
8. Turn the vehicle ignition off to exit the programming mode. Test all remote controls to ensure that they work properly.

Deleting Lost or Stolen Remote Controls from Your System

If one of your remote controls is lost or stolen, follow these instructions IMMEDIATELY to remove the control code from your system.

1. Have all remaining remote controls available.
2. Enter the control programming mode by following steps 1 - 5 of **Adding Remote Controls to Your System** (page 8).
- 3a. **If you have only one remaining remote control**, press the LOCK button on that remote control **eight (8) times**, pausing at least 1 second between each press. Make sure that the siren chirps each time you press the LOCK button.
- 3b. **If you have two remaining remote controls**, press the LOCK button on each remote control **four (4) times**, pausing at least 1 second between each press. Make sure that the siren chirps each time you press the LOCK button.
- 3c. **If you have three remaining remote controls**, press the LOCK button on the two remote controls **three (3) times**, then press the LOCK button on the remaining remote control **twice**. Pause at least 1 second in between each press. Make sure that the siren chirps each time you press the LOCK button.
4. Turn the vehicle ignition off to exit the programming mode. When you are finished, the lost or stolen remote control will no longer operate your system.

Emergency Override Procedure

9

If your remote control is lost or fails to function, use this procedure to disarm the Code Alarm CA-130™ and start your vehicle.

1. Use the keys to enter the vehicle.
The alarm will sound once the door is opened.
2. Insert the key into the ignition and turn to the ON position.
3. Locate and press the emergency override button.
The alarm will turn off and then you will be able to start your vehicle.

If the E-code coded override feature is enabled on your system, use this procedure to disarm the Code Alarm CA-130 and start your vehicle.

1. Use the keys to enter the vehicle.
The alarm will sound once the door is opened.
2. Insert the key into the ignition and turn to the ON position
3. Press and release the emergency override button the number of times that corresponds to the first digit of the code and turn the ignition key off.
4. Turn the ignition key to the ON position.
5. Press and release the emergency override button the number of times that corresponds to the second digit of the code and turn the ignition key off.
6. Follow steps 4 and 5 for the remaining two digits of the code. After the correct 4 digit code has been entered, the system will disarm.

Contact your installing dealer to change or activate you personal E-code.

Your Emergency Disarm Button is located:

10 **Basic Troubleshooting**

This section outlines some of the basic issues you may experience while becoming used to the Code Alarm CA-130™. If you have a problem that is not covered by this section, please consult your installer.

Symptom	Problem	Solution
Remote control does not work	Weak or dead battery	Change battery
	Remote control not programmed	Program remote control (page 8)
System will not arm	Door or other entrance is open	Close entrance
	Courtesy light is on	Turn courtesy light off
	System is in Valet mode	Turn off Valet mode (page 6)
System will not start	Hood is open	Close hood
	Brake is pressed	Release brake

Installer Programmed Options

Ignition On Door Lock	ON	OFF
Ignition Off Door Unlock	ON	OFF
Illuminated Entry/Exit	ON	OFF
Siren/Horn Chirps	ON	OFF
Passive Arming	ON	OFF
Passive Door Locks	ON	OFF

AUX1 Output Duration _____
 Light/AUX2 Output Duration _____
 AUX3 Output Duration _____
 AUX4 Output Duration _____

A. What is Personalized Transmitters option

Personalized Transmitter's when selected will activate an auxiliary when the unit receives an unlock command from the transmitter. This function would be used to activate memory seats or any other device that you wanted activated when unlocked .

B. How do Personalized Transmitters work?

Any Transmitter's that are learned as #1 will Activate (AUX) Three (3). When an unlock command is received

Any Transmitters that are learned as #2 will Activate (AUX) four (4). Whenever a unlock command is received.

FCC COMPLIANCE

This device complies with Part 15 of the FCC rules and with RSS-210 of Industry Canada. Operation is subject to the following two conditions:

1. This device may not cause harmful interference, and
2. This device must accept any interference received, including any interference that may cause undesired operation.

Warning!

Changes or modifications not expressly approved by the party responsible for compliance could void the user's authority to operate the equipment.

Code Systems, Inc. Limited Lifetime Warranty

A Code Systems Inc. ("CODE") vehicle comfort, convenience and security system sold to a retail consumer purchaser by an authorized dealer of CODE and installed by an authorized dealer of CODE is warranted by CODE to the original retail consumer purchaser to be free from defects in workmanship and materials for the lifetime of the vehicle in which the system was originally installed.

A CODE system sold to a retail consumer purchaser by an authorized dealer of CODE and installed by a party other than an authorized dealer of CODE is warranted by CODE to the original retail consumer purchaser to be free from defects in workmanship and materials for the lifetime of the vehicle. Defects caused by or related to the improper installation of the system are not covered by this or any other warranty.

The duration of this warranty described above applies to all components of the system except for: switches, indicator lights, transmitter(s) and accessories purchased separately.

Transmitters, exclusive of the transmitter case, are warranted by CODE to the original retail consumer purchaser to be free from defects in workmanship and materials for the lifetime of the vehicle in which the system was originally installed.

Switches, indicator lights, and transmitter cases are warranted to the original consumer purchaser for a period of one (1) year from the date of purchase when the system is installed by an authorized CODE dealer.

Code system accessories are covered by the warranty supplied with the accessory.

Wiring harnesses altered by installation and transmitter batteries are not covered by this or any other warranty.

This warranty is non-transferable, non-assignable and is completely voided when the system is removed from the car in which it was originally installed. If the vehicle in which the system was originally installed is transferred to another party, this warranty no longer applies.

This warranty does not apply to any product damaged by accident, physical or electrical abuse, improper installation, alteration, any use contrary to its intended function, unauthorized service (i.e. service by anyone other than CODE or its authorized service personnel), fire, flood, lightning or other acts of God.

Should a product be found to be defective during the warranty duration, CODE will repair or replace the system or any part of the system that CODE agrees is defective without charge to the retail consumer purchaser of the system during the first year of the warranty period. After the first year of the warranty period has expired CODE will repair or replace the system or any part of the system that CODE agrees is defective for a fee of \$10.00 to cover shipping and handling charges.

In order for the system to be repaired or replaced under the terms of this warranty, the defective product must be returned to an authorized CODE dealer and accompanied by a copy of the original retail sales receipt. The date of purchase and year, make and model of the vehicle in which the security system was originally installed must be clearly indicated on the sales receipt.

CODE shall not be held responsible for any removal and/or reinstallation charges of a defective system, damage to or theft of the vehicle or its contents, or any incidental or consequential damages caused by any failure of the system to function properly. Under no circumstances should this warranty, or system covered by it, be construed as an insurance policy against loss. CODE neither assumes nor authorizes any person or organization to make ANY WARRANTIES or assume any liability in connection with the sale, installation, or use of this system. This is the complete CODE warranty and no other warranty exists.

The warranty identified in this form is exclusive and CODE makes no other warranties expressed or implied for any goods or services provided by CODE. CODE specifically and expressly excludes any other warranties including the fitness for a particular purpose and all warranties of merchantability. The customers sole and exclusive remedy for any and all claims against CODE arising out the customers use of any CODE system shall be as delineated in the warranty set forth above. CODE shall not be liable to any customer or any other person or entity for any direct or indirect, consequential, special or exemplary damages arising out of or in connection with the customers use of, or inability to use, or misuse of any CODE provided system.

Some states do not allow the exclusion or limitation of incidental or consequential damages, so the above limitation may not apply to you. This warranty gives you specific legal rights, and you may also have other rights which vary from state to state.

Code System, Inc. Theft Protection Guarantee

13

The Theft Protection Program is designed to provide the retail purchaser of a security system provided by CODE-ALARM, INC. ("CODE") an additional benefit, at no additional cost to the purchaser, should their vehicle be stolen while protected by a CODE-ALARM security system. While CODE has created this program as a way of showing appreciation to its customers, CODE RESERVES THE RIGHT TO UNILATERALLY CHANGE, ALTER, MODIFY, OR DISCONTINUE ALL OR PART OF THIS THEFT PROTECTION PROGRAM WITHOUT PRIOR NOTICE. THIS THEFT PROTECTION PROGRAM IS NOT AN INSURANCE POLICY AND SHOULD NOT REPLACE AN AUTOMOBILE OR HOMEOWNERS INSURANCE POLICY. THIS THEFT PROTECTION PROGRAM DOES NOT COVER LOSSES ARISING FROM THE THEFT OF ITEMS WITHIN THE AUTOMOBILE OR ANY DAMAGES ARISING FROM, RELATED TO, AND/OR INCIDENTAL OR A CONSEQUENCE OF A VEHICLE THEFT EXCEPT AS SPECIFICALLY DELINEATED BELOW.

Plan duration: 3 Years from the date of installation.

Plan amount: Maximum allowable value equal to insurance deductible or up to \$2,500 whichever is less.

Conditions of the Theft Protection Program:

1. The Theft Protection Program is non-transferable and non-assignable.
2. The system must be installed by an authorized CODE dealer.
3. Vehicle must be less than three (3) model years old at the time of installation.
4. The security system must have been fully armed at the time of the vehicle theft.
5. The vehicle in which the system is installed must be insured for theft by a licensed insurance underwriter in the state in which the vehicle is registered.

Terms of payment:

1. The vehicle must first be considered a total loss due to theft by your insurance company.
2. Your insurance company has settled all claims arising from this theft and there are no other pending legal actions as a result of this theft.

How to file a request for payment:

If the above conditions are met, make your request for payment by submitting the following to CODE. The request for payment must be received by CODE no later than sixty (60) days after the vehicle is reported stolen.

1. Copy of the retail sales receipt for the purchase of the security system, clearing showing the model of system purchased and the year, make and model of the vehicle in which the system was installed.
2. A copy of the police report for the stolen vehicle.
3. A copy of the paid insurance claim and reimbursement check from the insurance company.

***The Theft Protection program is not available in all states please contact dealer for more information.**

**CODE SYSTEMS, INC.
1-800-421-3209**

